

352671 f = 4.02mm and 0.60 NA

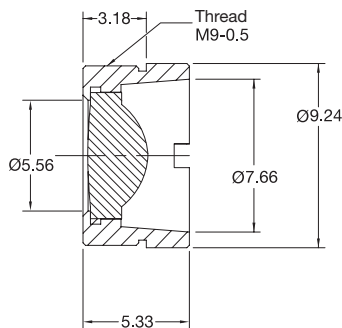

C671TME
Mounted Lens

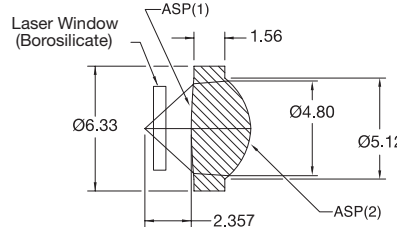

352671
Unmounted Lens

All Dimensions Are in Millimeters

Geltech™ Molded Glass Aspheric Collimator Lens

Optical Design Specifications

- Design Wavelength: 408nm
- Numerical Aperture: 0.60
- Clear Aperture: 4.80mm
- Effective Focal Length: 4.02mm
- Working Distance: 2.37mm
- Magnification: Infinite
- RMS WFE (Axial @ 632.8nm)¹: <Diffraction Limit
- Scratch-Dig: 40-20
- Glass (Corning): ECO550

¹ Averaged over full aperture

Geltech™ lenses are manufactured by LightPath® Technologies

Aspheric Coefficients

	R	k	A ₄	A ₆	A ₈	A ₁₀
ASP (2)	2.71	-0.9975580	2.5986960E-03	2.3695380E-05	-3.6503380E-06	-
ASP (1)	-19.51	-	7.7298730E-04	-	-	-

Unmounted AR Coated Aspheric Lens

ITEM #	\$	£	€	RMB	DESCRIPTION
352671-A	\$ 115.00	£ 72.50	€ 107.00	¥ 1,098.30	Lens, AR Coated 400-600nm

Mounted AR Coated Aspheric Lens

ITEM #	\$	£	€	RMB	DESCRIPTION
C671TME-A	\$ 136.00	£ 85.70	€ 126.50	¥ 1,298.80	Mounted Lens, AR Coated 400-600nm

350340 f = 4.03mm and 0.62 NA

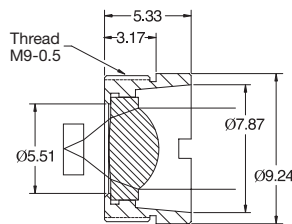

C340TM
Mounted Lens

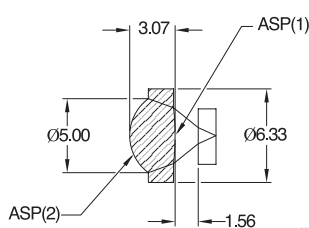

350340
Unmounted Lens

All Dimensions Are in Millimeters

Geltech™ Molded Glass Aspheric Lens

Optical Design Specifications

- Design Wavelength: 685nm
- Numerical Aperture: 0.62
- Clear Aperture: 5.00mm
- Effective Focal Length: 4.03mm
- Magnification: Infinite
- Laser Window Thickness: 1.20mm

- Laser Window Material/Index: K3/1.518
- RMS WFE (Axial @ 632.8nm)¹: <Diffraction Limit
- Scratch-Dig: 40-20
- Glass (Corning): C0550

¹ Averaged over full aperture

Geltech™ lenses are manufactured by LightPath® Technologies

Aspheric Coefficients

	R	k	A ₄	A ₆	A ₈	A ₁₀
ASP (2)	2.77	-0.5333481	4.2020960E-04	-7.4938670E-05	2.4030490E-05	-3.1803610E-06
ASP (1)	-10.99	16.0276600	9.2024790E-03	-9.1626290E-04	2.8005320E-05	6.7433645E-06

Unmounted AR Coated Aspheric Lenses

ITEM #	\$	£	€	RMB	DESCRIPTION
350340-A	\$ 84.00	£ 52.90	€ 78.10	¥ 802.20	Lens, AR Coated 400-600nm
350340-B	\$ 84.00	£ 52.90	€ 78.10	¥ 802.20	Lens, AR Coated 600-1050nm
350340-C	\$ 84.00	£ 52.90	€ 78.10	¥ 802.20	Lens, AR Coated 1050-1600nm

Mounted AR Coated Aspheric Lenses

ITEM #	\$	£	€	RMB	DESCRIPTION
C340TM-A	\$ 89.00	£ 56.10	€ 82.80	¥ 850.00	Mounted Lens, AR Coated 400-600nm
C340TM-B	\$ 89.00	£ 56.10	€ 82.80	¥ 850.00	Mounted Lens, AR Coated 600-1050nm
C340TM-C	\$ 89.00	£ 56.10	€ 82.80	¥ 850.00	Mounted Lens, AR Coated 1050-1600nm